

The **XCD-SX900** is a high-resolution black and white C-mount camera module incorporating the latest 1/2" Interline (IT) progressive scan 1,450,000 pixel CCD. This new age digital camera has an IEEE1394 digital interface, producing new levels of precise and detailed images for industrial applications. With its one-piece, self contained body, the **XCD-SX900** can be easily installed and features high shock and vibration tolerance, making it ideal for use in demanding factory automation and high resolution image processing systems.

The **XCD-X700** incorporates a 1/2" Interline (IT) progressive scan 800,000 pixel CCD and possesses the same features as the **XCD-SX900**. Both models incorporate an external trigger, allowing fast moving objects to be captured clearly.



XCD-SX900 XCD-X700

Component/OEM



FEATURES

- High resolution video format SXGA, 1280(H) x 960(V) (XCD-SX900) XGA, 1024(H) x 768(V) (XCD-X700)
- C-mount
- High speed IEEE1394 digital interface
- 1394-based Digital Camera Specification (Ver.1.20)
- External trigger function (BNC input)
- Scalable function (selectable combination of 16 zones)
- High shock and vibration tolerance
- Square pixels

OPTIONAL ACCESSORY

PCI Lynx II host adaptor card **DFWA-400**

- IEEE1394 - 1995 connectors (x 3)
- 100 M / 200 M / 400 Mbps high data rate transmission
- Asynchronous and Isochronous transmission support
- Isochronous cycle master function support
- FCC and CE approval
- Windows NT 4.0 driver included



www.pro.sony-europe.com/isp

SONY

SPECIFICATIONS

	XCD-SX900	XCD-X700
Image device	1/2" IT CCD	
Effective picture elements	1,450,000; 1392 (H) x 1040 (V)	800,000; 1034 (H) x 779 (V)
Video format	SXGA (1280 x 960)	XGA (1024 x 768)
Cell size	4.65 x 4.65 μm	6.25 x 6.25 μm
Lens mount	C mount	
Minimum illumination	4 lx (F 1, Gain +18 dB)	
Digital interface	IEEE1394	
Transfer rate	400 Mbps	
Frame rate	7.5 or 3.75 frames/s	15 or 7.5 frames/s
Gain control	Manual (0~18 dB)	
External shutter	1/100,000 ~ 2 s	
External trigger shutter	Yes	
Scalable function	16 zones (4 x 4)	
Power requirements	DC 8 ~ 30 V	
Power consumption	3.0 W	
Dimensions	44 (W) x 33 (H) x 116 (D) mm (1 3/4 x 1 15/16 x 4 5/8 inches)	
Mass	250 g (9 oz)	
Operation temperature	-5 ~ + 45 °C	
Storage temperature	-30 ~ + 60 °C	
Vibration	10 G (20 ~ 200 Hz)	
Shock resistance	70 G	
Regulations	UL1492, FCC Class A Digital Device, CE (EN50081-2 + EN50082-2), AS4251.1 + AS/NZS 3548/95 Class A	
Supplied accessories	Lens mount cap (x 1), Operating instructions (x 1), Cable (x 1), Clamp filter (x 2)	

DIMENSIONS

Unit:mm

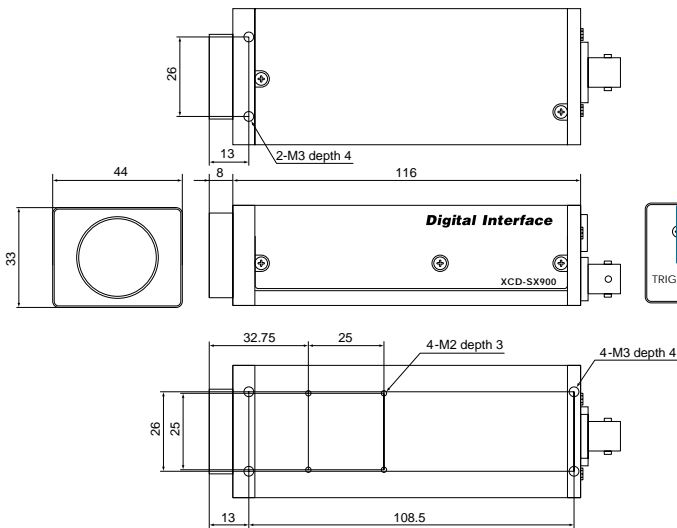

PIN ASSIGNMENT

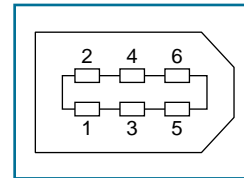

- 1: Power
- 2: Power (GND)
- 3: TPB-
- 4: TPB+
- 5: TPA-
- 6: TPA+

TRIGGER SHUTTER

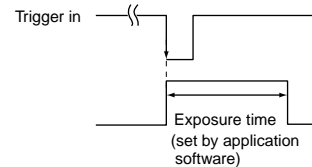

Product information is available on the ISP Home Page

Click!

<http://www.sony.co.jp/ISP/>

Sony online <http://www.pro.sony-europe.com/isp>

Sony Austria (ISP) +43 1 610 50 214
 Sony Belgium (ISP) +32 2 724 18 24
 Sony France (ISP) +33 1 55 90 41 58
 Sony Germany (ISP) +49 221 59 66 322
 Sony Italy (ISP) +39 02 61 83 84 06
 Sony Netherlands (ISP) +31 20 658 1502
 Sony Nordic (ISP) +46 40 19 08 06
 Sony Spain (ISP) +34 93 402 65 54
 Sony Switzerland (ISP) +41 1 733 3477
 Sony UK (ISP) +44 1932 816 340

© 2000 Sony Corporation. All rights reserved.
 Reproduction in whole or in part without written permission is prohibited.
 Design and specifications are subject to change without notice.

CA XCD-SX900/X700/GB-24/01/2000